



Place of Reflection Update

City Culture
Arts & Culture

Acknowledgement of Country

The City of Adelaide acknowledges that we are located on the traditional Country of the Kaurna people of the Adelaide Plains and pays respect to Elders past, present and emerging.

We recognise and respect their cultural heritage, beliefs and relationship with the land. We also extend that respect to visitors of other Aboriginal Language Groups and other First Nations.



Overview: A Place of Reflection

- The Place of Reflection is a high-profile public artwork in the City of Adelaide that acknowledges the strength and resilience of the Stolen Generations, their families and friends, and the wider community.
- It has been an Aboriginal-led commission informed and developed in consultation with the Aboriginal community including the experiences of the Stolen Generations and their stories.
- The Place of Reflection Advisory Group has included representatives from: Kaurna Nation Cultural Heritage Association, Healing Foundation /Link Up, Nunkuwarrin Yunti, Journey of Healing, Reconciliation Committee, Stolen Generation Alliance, Kaurna Yerta Aboriginal Corporation, Reconciliation South Australia, Tandanya National Aboriginal Institute, and the Art Gallery of South Australia.
- This work has been an important action in the City of Adelaide's reconciliation journey and was a key action in the City of Adelaide's Stretch Reconciliation Plan (2015-2018).
- The work is located within Murlawirrapurka / Rymill Park alongside Tandanya National Aboriginal Institute.



Artists and Creative Team

- The Place of Reflection has been led by respected Elder and artist Aunty Yvonne Koolmatrie, who has created the artwork in collaboration with artist / designer Karl Meyer, supported by Exhibition Studios.
- Exhibition Studios, is a nationally recognised creative studio that design and fabricate innovative and engaging works and immersive and interactive spaces.
- Additional creative support and collaborators in the process have included:
 - Ochre Dawn & Rebecca Wessels who facilitated artist workshops supported by Aboriginal artists, Cedric Varcoe & Sonya Rankine
 - Wax Design for landscape design and planting selection.

Respected Elder and artist
Aunty Yvonne Koolmatrie



Funding and Timeline

The Place of Reflection project was initiated and managed by City of Adelaide and delivered in partnership with the Government of South Australia.

The total commission budget for the Place of Reflection is \$265,000:

- City of Adelaide has contributed \$150,000 from its Public Art Capital Budget
- Government of South Australia (Department of Premier and Cabinet) has contributed \$115,000 through:
 - Arts South Australia (\$15,000)
 - Stolen Generations (Community) Reparations Scheme (\$100,000) administered by the Department of Aboriginal Affairs and Reconciliation

The Place of Reflection project was in development for a substantial period and was guided through that the process by the Project Advisory Group, Project Partners and the community.

The public art commissioning process has been in delivery over the last 24 months. Key stages of this process included the opportunity development with the Project Advisory Group, Concept Design, Design Development, Workshops with Project Advisory Group and community, Fabrication and Installation.



Concept Design

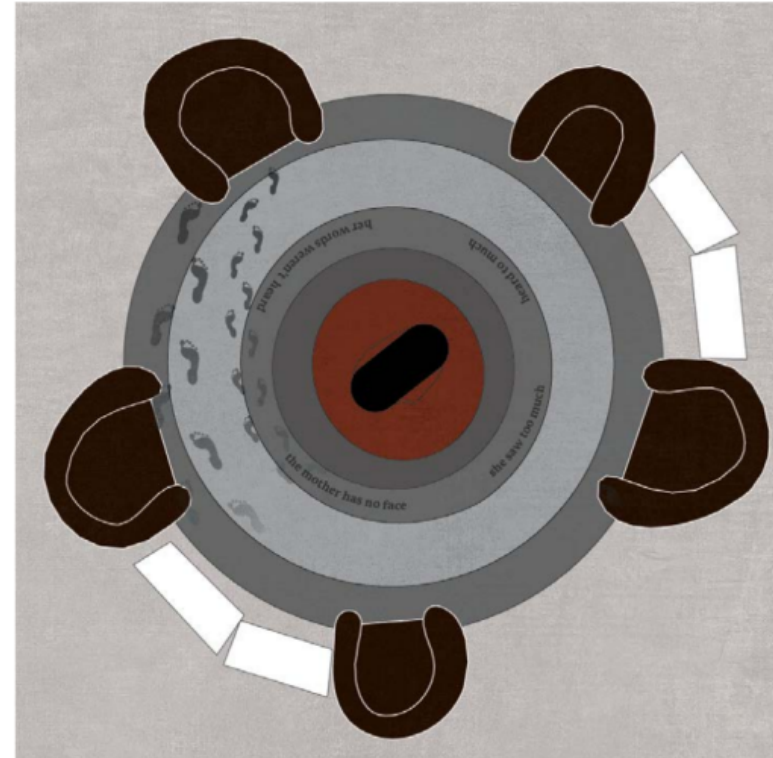
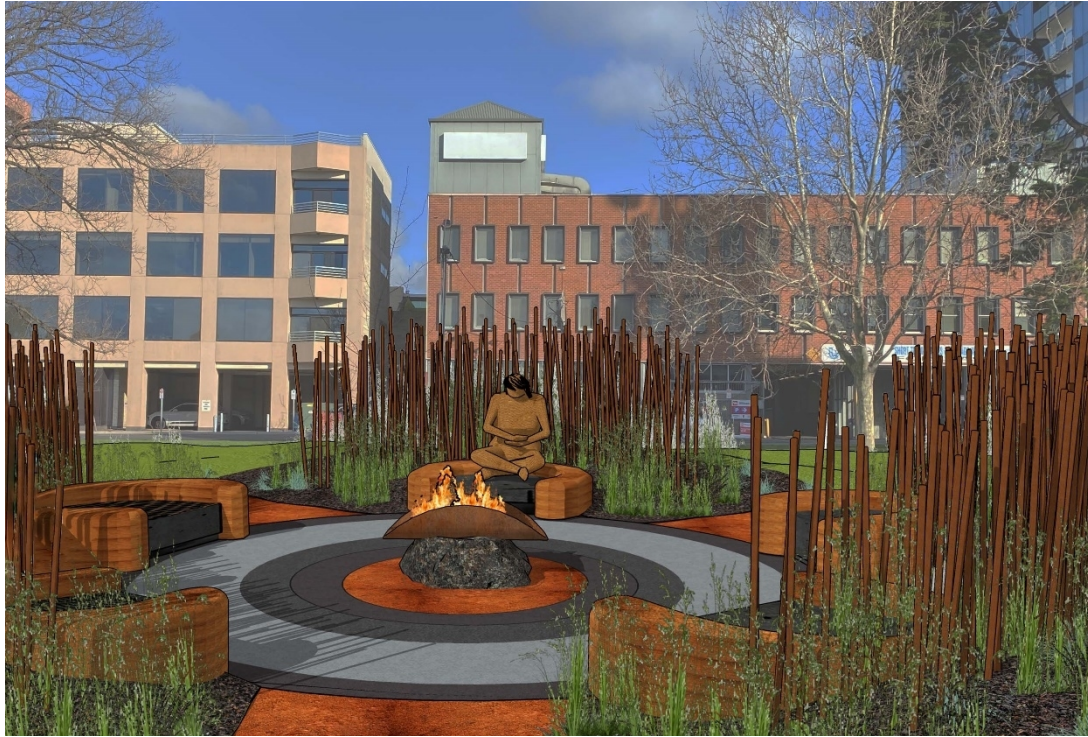

Artwork Development

Workshops with Aunty Yvonne Koolmatrie at Tandanya National Aboriginal Cultural Institute to inform artwork development



Artwork Development and Fabrication

Development and final form – Mother Figure Sculpture

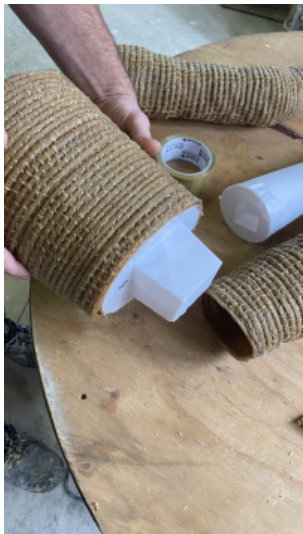

Unveiling Ceremony and Community Event

Now that the **Place of Reflection** has been completed:

- An unveiling ceremony and community event will be held at 10am on Thursday 14 September 2023.
- The occasion will be an opportunity for the community to heal, reflect and acknowledge the strength and resilience of the Stolen Generations, their families and friends.
 - The ceremony and event will include speeches, live music and spoken word.
- There is an open invitation for the community to join the ceremony and event.
- The ceremony and event has been informed by consultation with Project Advisory members and partners.
- Project partners have offered event support to ensure cultural safety with appropriate protocols in place.
 - Event support for community members includes counselling services and healing resources.

